



## **DATALOGIC'S STAR AND STAR2.0 CORDLESS SYSTEM™ FOR NARROW BAND RADIO COMMUNICATIONS**

When using a mobile scanning solution, customers must choose the type of RF radio frequency to use in order to transmit scanned data to a base station. There are several key factors to consider when choosing a radio: the amount of data to be transmitted, the mobility range in the workplace, interference from other RF systems, existing physical barriers, the cost of the radio, and the life span of the battery.

Datalogic offers the perfect solution to this challenge with the STAR and STAR2.0 Cordless System™ narrow band radios. The STAR radio is an affordable solution that features total mobility and real-time communications, free from cable restraints and entanglement. The STAR2.0 also features high speed communications and wide radio coverage (up to 150 m / 492 ft).

The network capability of the STAR radio features point-to-point connections, point-to-multipoint connections as well as network connections via RS-485 or Ethernet (only available on STAR2.0), making the STAR and the STAR2.0 Cordless Systems the most versatile and effective radio systems, capable of transmitting 1D linear or 2D bar codes.

The STAR radio is more versatile than other RF systems, offering greater mobility in the workplace, expandability with more handheld readers per base station, and flexibility with more users able to use the same frequency without interference or disruptions. Additionally, the STAR and STAR2.0 Cordless Systems are much less sensitive to obstacles such as concrete walls, firewalls or metal shelving, contributing to greater system efficiency.

When scanning activities take the user outside the radio range, all of the scanned data is stored in the handheld wireless scanner. Upon re-entering the radio range, the data is transmitted to the base station, providing seamless scanning and coverage throughout the workplace.

## **BENEFITS**

- Available in 433 MHz or 910 MHz radio frequencies
- Point-to-point and multi-point configurations
- Real-time communications
- Seamless roaming provides secure coverage with no interruptions
- No interference with Wi-Fi infrastructure
- Low sensitivity to obstacles ensuring more stable connectivity
- STAR communications are free from open standards, providing better security for your transmitted data

### **STAR2.0 Total Mobility Range**

- 433 MHz: 100 m / 328 ft (low speed); 50 m / 164 ft (high speed)
- 910 MHz: 150 m / 492 ft (low speed); 100 m / 328 ft (high speed)
- Networking via RS-485 and Ethernet

### **STAR Cordless System™ is Available on the Following Products:**

- Gryphon™ | GM4100 Series
- Gryphon™ | GM4400 2D Series
- PowerScan™ PM8300

### **STAR2.0 Cordless System™ is Available on the Following Products:**

- PowerScan™ PM9500 Series
- PowerScan™ PM9500-DPM
- QuickScan™ QM2400

## DATALOGIC'S STAR CORDLESS SYSTEM™ - THE POWER OF VERSATILITY

### MOBILITY

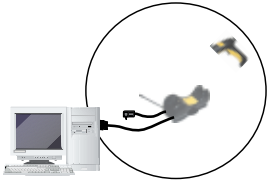

### TEAMWORK

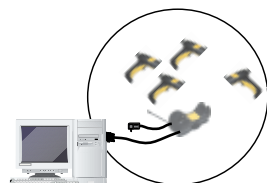

### NETWORK

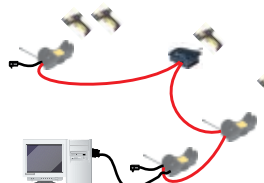

### INTEGRATED NETWORK

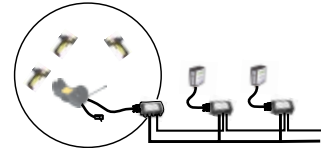



| Single Reader Layout                                    | Multi-Reader Layout                           | Network Layout   | Integrated Network Layout   |
|---|---|--|---|
| (Cable replacement - one operator at each work station) | (Up to 32 operators at the same work station) | (Up to 255 operators in an area exceeding 100,000m <sup>2</sup> covered by up to 16 cradles) | (Transparent connection of 1 or more manual stations in a 'fixed position scanner' network) |

| Typical Configuration: | Typical Configuration: | Typical Configuration:        | Typical Configuration: |
|------------------------|------------------------|-------------------------------|------------------------|
| 1 Reader               | X Readers (up to 32)   | X Readers (up to 255)         | X Readers (up to 32)   |
| 1 Cradle               | 1 Cradle               | X Cradles (up to 16)          | 1 Cradle               |
| 1 Interface Cable      | 1 Interface Cable      | 1 Interface Cable             | 1 Interface Cable      |
|                        | X Single Chargers      | X Battery Chargers            | X Single Chargers      |
|                        |                        | X-1 RS-485 Base-to-Base Cable | 1 C-Box                |

All layouts and applications can benefit from additional accessories specifically designed to eliminate downtime caused by the need for recharging:

- Multi-Battery Charger (4 Slots)
- Spare Battery Slot
- Removable Battery Pack

## A COMPARISON BETWEEN THE STAR CORDLESS SYSTEM™ AND BLUETOOTH® WIRELESS TECHNOLOGY

| Key Factors                      |  |  |  |
|----------------------------------|---|--|---|
| Battery Life                     | ✓   | ✓  | ⚠   |
| Interference with Wi-Fi          | ✓   | ✓  | ⚠   |
| Networking                       | ✓   | ✓  | ✗   |
| Full 2-Way Communications        | ✓   | ✓  | ⚠   |
| High Speed Communications        | ✗   | ✓  | ✓   |
| Frequency Agility                | ✗   | ✓  | ✗   |
| Exceeds 100 m/328 ft Radio Range | ✗   | ✓  | ✗   |
| Built-in MAC Address             | ✗   | ✓  | ✓   |

### ADDITIONAL DATALOGIC STAR PRODUCTS

**STAR-Modem** is an industrial radio modem enabling wireless communications between Datalogic narrow band RF devices and a host system. In a basic point-to-point configuration, it transmits via radio any string received through its RS-232 port and vice versa.

- STAR-Modem offers both RS-232 and Keyboard Wedge connections and can make RS-232 cabled devices instantly wireless
- Specifically designed for industrial use, the STAR-Modem can operate in all environmental conditions including outdoor applications without affecting functionality
- STAR-Modem resists vibrations and mechanical stress, allowing for installation into vehicles such as forklifts



STAR-Modem™ is compatible only with the STAR radio

